



Forming The Future™

PATTERN 16914 Weathered Plank

6" Wide Heavy Grain Wooden Plank

Vac-U-Form™

Styrene - Single Use.
ABS Plastic - Up to 15 reuses.

Wooden Plank

Size: 120" W x 48" H
Max Depth: 0.125"
Grain: Heavy

No Interior Butt Joints
No Groove or space between boards

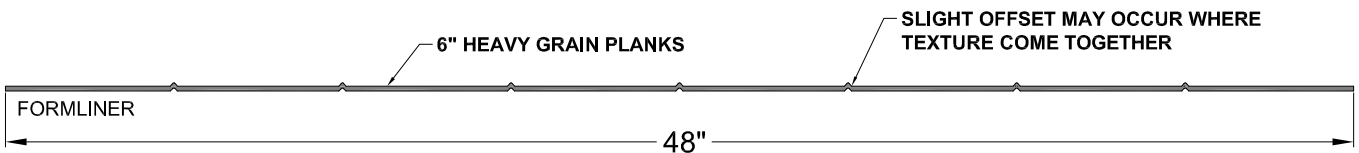
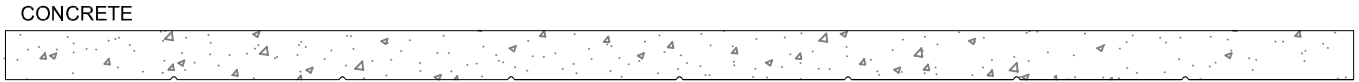
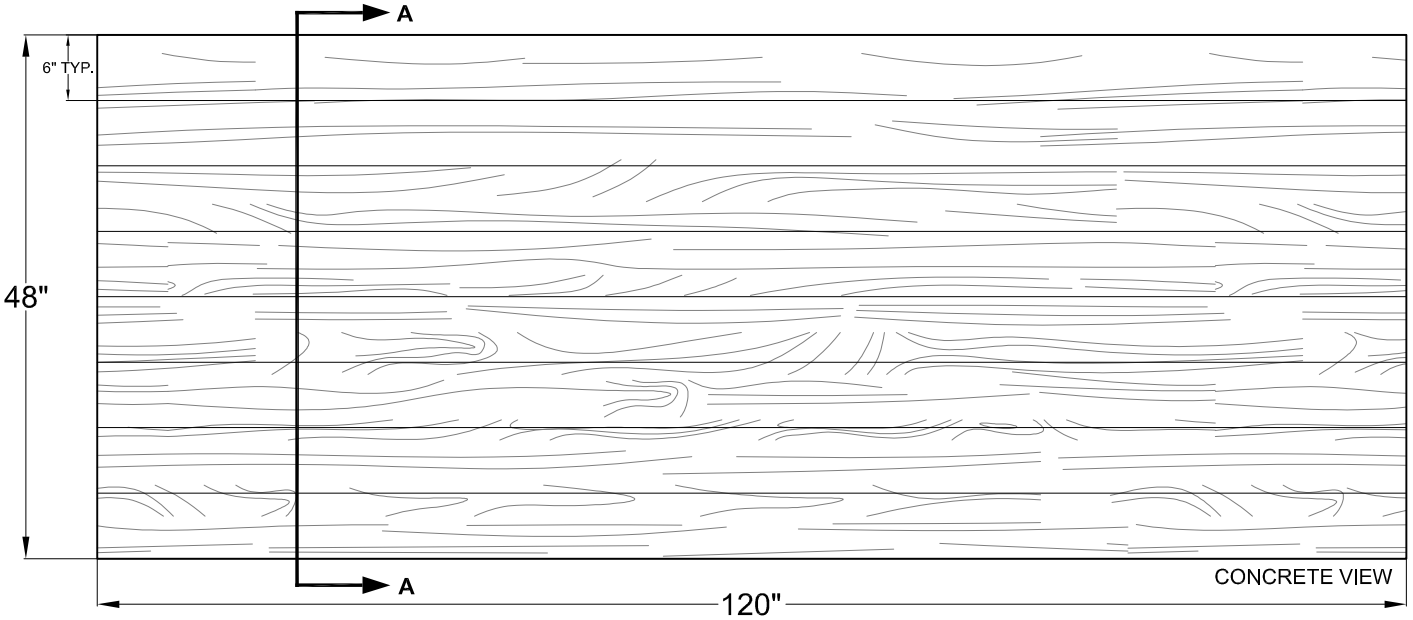

SECTION A-A
FORMLINER DETAIL

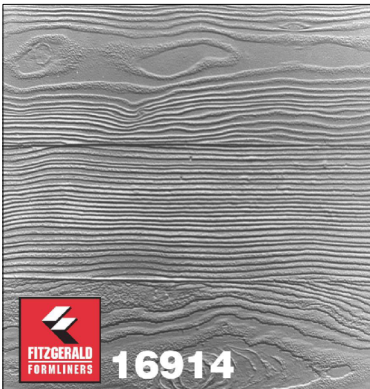

This document contains confidential and proprietary information of Fitzgerald Formliners, Inc. and is protected by copyright, trade secret, and other state and federal laws. Its receipt or possession does not cover any rights to reproduce, disclose its contents, or to manufacture, use, or sell anything it may describe. Reproduction, disclosure, or use without specific written authorization of Fitzgerald Formliners, Inc. is strictly forbidden.

FITZGERALD FORMLINERS

1500 East Chestnut Avenue • Santa Ana, CA 92701 • Fax (714) 245-9715
Ph: (800) 547-7760 • Ph (714) 547-6710 • www.formliners.com

Pattern can be requested in AutoCad format.

File Name: S-16914-VF-3-22-18

Page 1 of 1